



New South Wales

# **Blue Mountains Local Environmental Plan 2005 (Amendment No 1)**

under the

Environmental Planning and Assessment Act 1979

I, the Minister for Planning, make the following local environmental plan under the *Environmental Planning and Assessment Act 1979*. (P04/00170/PC)

TONY KELLY, MLC  
Minister for Planning

## 2010 No 314

Clause 1 Blue Mountains Local Environmental Plan 2005 (Amendment No 1)

---

### **Blue Mountains Local Environmental Plan 2005 (Amendment No 1)**

under the

Environmental Planning and Assessment Act 1979

#### **1 Name of Plan**

This Plan is *Blue Mountains Local Environmental Plan 2005 (Amendment No 1)*.

#### **2 Commencement**

This Plan commences on the day on which it is published on the NSW legislation website.

#### **3 Land to which Plan applies**

This Plan applies to land in the City of Blue Mountains, being:

- (a) certain land in Lawson, Hazelbrook, Springwood and Blaxland as referred to in Schedule 1 [1]–[10] to this Plan, and
- (b) certain land in Lawson, Hazelbrook, Springwood and Blaxland as shown by distinctive colouring, edging, hatching and lettering on Sheets 1A, 1B and 2–4 of the map marked “Blue Mountains Local Environmental Plan 2005 (Amendment No 1)” deposited in the office of the Blue Mountains City Council.

---

## Schedule 1      Amendment of Blue Mountains Local Environmental Plan 2005

**[1] Schedule 6 Heritage**

Omit the matter relating to Honour Avenue, Lawson (LN014) from Part 1.

**[2] Schedule 6, Part 1**

Insert in alphabetical and numerical order of street or place name and number (and, where there is no number, as the first entry for the street name where appropriate) in the matter relating to Lawson under the headings “**Address**”, “**Name**” and “**Number**”, respectively:

4 Bellevue Street	Residence	LN046
5 Bellevue Street	“Chester”	LN047
4 Benang Street	Residence	LN052
9 Benang Street	Residence	LN051
11 Benang Street	Residence	LN048
15 Benang Street	Residence	LN050
Great Western Highway	Entry Arch to Bellevue Park	LN049
Great Western Highway	Explorers’ Centenary Lamp, Bellevue Park	LN042
230 Great Western Highway	Gardener’s cottage to “Kihilla”	LN036
241 Great Western Highway	House	LN037
279A Great Western Highway	Lawson Baptist Church	LN041
281 Great Western Highway	“Tahlia” and cherry tree	LN039
284 Great Western Highway	Lawson Community Hall	LN043
286 Great Western Highway	Blue Mountains Hotel	LN080
309 Great Western Highway	“Athol”	LN056
313 Great Western Highway	“Bangalore”	LN057
314 Great Western Highway	“Keira”	LN058
323 Great Western Highway	“Pilcharra”	LN059
1–7 Honour Avenue	Staples Store group	LN077
4 Honour Avenue	Grand Hotel—archaeological site	LN078
24 Honour Avenue	“Vera”	LN062

## 2010 No 314

### Blue Mountains Local Environmental Plan 2005 (Amendment No 1)

#### Schedule 1 Amendment of Blue Mountains Local Environmental Plan 2005

---

26 Honour Avenue	“Creswell”	LN063
2 and 6 Loftus Street	Former railway reservoir	LN026
Main Western Railway—about 30 metres west of Ferguson Avenue northside and adjacent to railway track	Railway culvert	LN067
Main Western Railway—opposite Charles Street	Railway culvert	LN075
Main Western Railway—opposite 268 Great Western Highway	Railway culvert	LN070
15 Mary Street	Residence	LN035
27 Mary Street	“Maria Dona”	LN038
31 Mary Street	Residence	LN040
36 Mary Street	Lawson Reservoir	LN045
2 Queens Oak Road	“Hollywood”	LN066

#### [3] Schedule 6, Part 1

Omit the matter relating to Gloria Park, Hazelbrook (H005).

#### [4] Schedule 6, Part 1

Insert in alphabetical and numerical order of street name and number in the matter relating to Hazelbrook under the headings “**Address**”, “**Name**” and “**Number**”, respectively:

15 Addington Road	“The Willows”	H004
16 Addington Road	“Lilac Cottage”	H021
17–19 Addington Road	“Budgeecumbah”	H020
17 Landseer Road	“Monica”	H019
21A Lester Avenue	Gloria Park and war memorial	H022
33 and 34 Railway Parade	“Editon” and shop	H014
35 Railway Parade	Store	H015
37, 38 and 39 Railway Parade	Commercial group of buildings	H016
46 Railway Parade	“Ortona”	H023
46 Railway Parade	“Ortona” (part of Railway Parade group)	H008
47 Railway Parade	“Bonnie Doon” (part of Railway Parade group)	H008

---

49 Railway Parade	“Glenalpine” (part of Railway Parade group)	H008
51 Railway Parade	“Sunnybrae” (part of Railway Parade group)	H008
6 Terrace Falls Road	“Yerranderie”	H017
12 Terrace Falls Road	“Hertford”	H018

**[5] Schedule 6, Part 1**

Insert in alphabetical and numerical order of street name and number in the matter relating to Springwood under the headings “**Address**”, “**Name**” and “**Number**”, respectively:

1, 2 and 3 Ferguson Road	Group of cottages	SP062
12 Ferguson Road	“Warrah”	SP063
14 Ferguson Road	“Surrey”	SP064
86–88 Macquarie Road	“The Knoll”	SP053
90–92 Macquarie Road	“Nirvana”	SP054
94–96 Macquarie Road	“Caberfeagh”	SP055
180–184 Macquarie Road	Site of former Springwood School of the Arts	SP065
202–210 Macquarie Road	Colless’ Building	SP057
212–218 Macquarie Road	Ryan House	SP058
246 Macquarie Road	Shop	SP059
3 Station Street and 272 Great Western Highway	“Innisfail”	SP061

**[6] Schedule 6, Part 1**

Omit “drive,” from the matter relating to 101–105 Macquarie Road, Springwood (SP031).

Insert instead “Dr”.

**[7] Schedule 6, Part 1**

Insert in alphabetical and numerical order of street name and number in the matter relating to Blaxland under the headings “**Address**”, “**Name**” and “**Number**”, respectively:

23 Hope Street and 14A–16A and 18 View Street	Hargrave–Calver group of houses and gardens	BX011
---	---	-------

**2010 No 314**

Blue Mountains Local Environmental Plan 2005 (Amendment No 1)

Schedule 1 Amendment of Blue Mountains Local Environmental Plan 2005

---

**[8] Schedule 6, Part 2**

Omit the 2 maps (and the respective headings) for land at Lawson (LN025 and LN030 State\*).

Insert instead:

Address	Name	Number
<b>Lawson</b>		
Honour Avenue	Honour Gardens Conservation Area	LN014

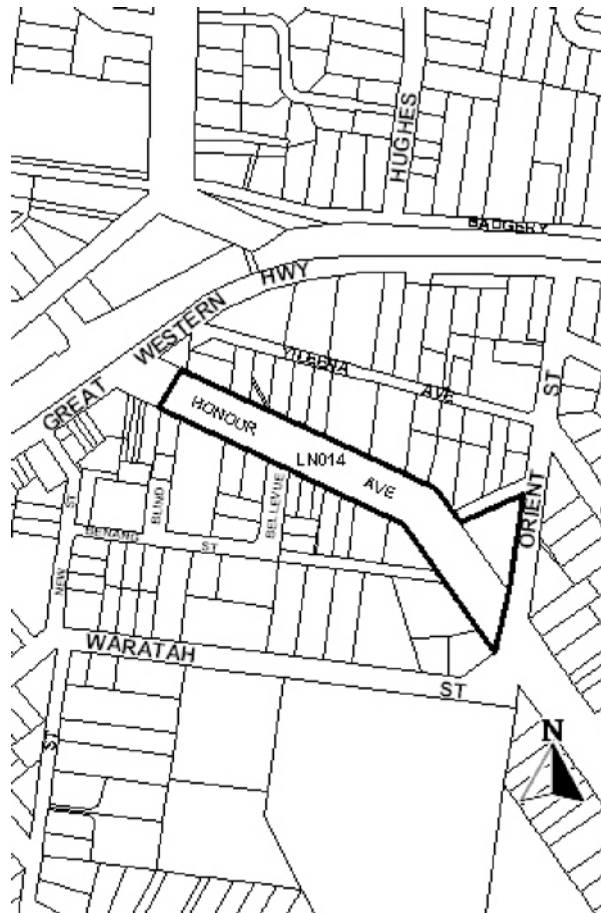

---

Address	Name	Number
<b>Lawson</b>		
309 Great Western Highway and 2, 4, 6, 8, 10, 12, 15, 17 and 19 Henry Street	Henry Street Cottages Conservation Area	LN025

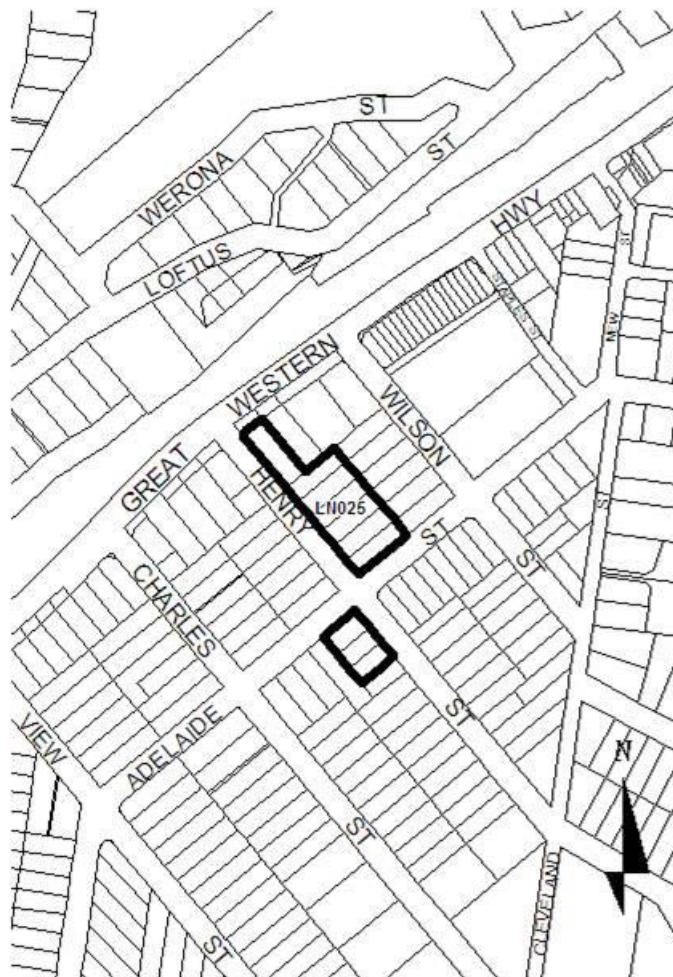

**2010 No 314**

Blue Mountains Local Environmental Plan 2005 (Amendment No 1)

Schedule 1 Amendment of Blue Mountains Local Environmental Plan 2005

---

Address	Name	Number
<b>Lawson</b> San Jose Avenue and Badgerys Crescent	San Jose Avenue and Badgerys Crescent Cottages Conservation Area	LN030 State*

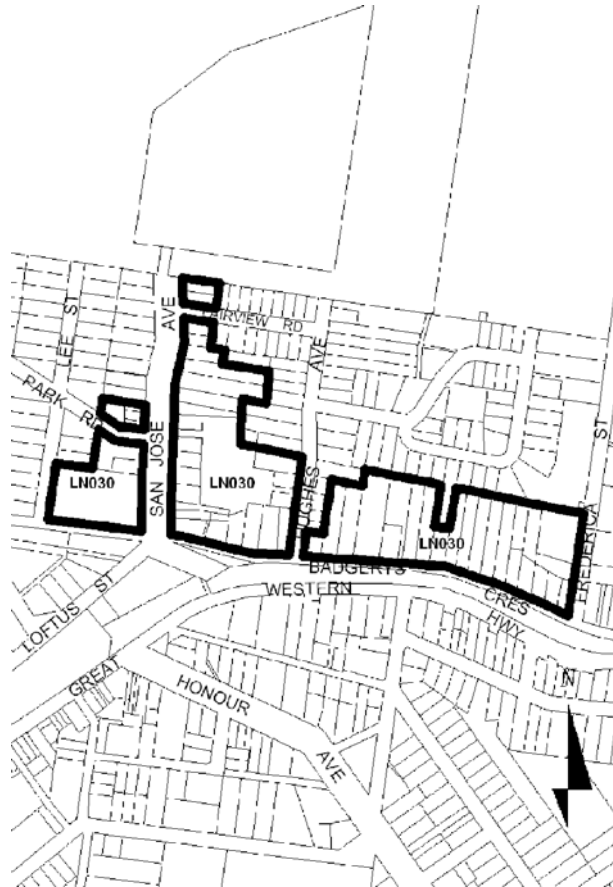



**[9] Schedule 6, Part 2**

Insert after the maps for land at Lawson:

Address	Name	Number
<b>Springwood</b>		
79-105 and 86-120 Macquarie Road	Macquarie Road Conservation Area	SP056

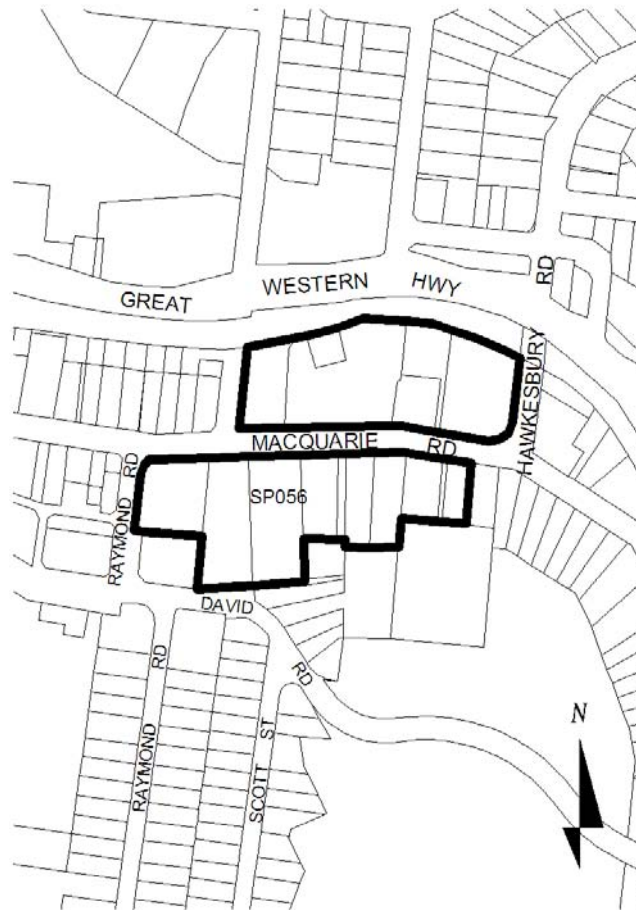

## **2010 No 314**

Blue Mountains Local Environmental Plan 2005 (Amendment No 1)

Schedule 1      Amendment of Blue Mountains Local Environmental Plan 2005

---

**[10] Schedule 6, Part 2**

Omit the 1 map (and respective headings) for land at Hazelbrook (H010).

**[11] Dictionary**

Insert “, tree” after “archaeological site” in paragraph (a) of the definition of *heritage item*.

**[12] Dictionary, definition of “the Map”**

Insert in appropriate order:

Blue Mountains Local Environmental Plan 2005 (Amendment No 1)—  
Sheets 1A, 1B and 2–4