



New South Wales

Sutherland Shire Local Environmental Plan 2000 (Amendment No 6)

under the

Environmental Planning and Assessment Act 1979

I, the Minister for Planning, make the following local environmental plan under the *Environmental Planning and Assessment Act 1979*. (S01/00033/S69)

ANDREW REFSHAUGE, M.P.,

Minister for Planning

2002 No 156

Clause 1 Sutherland Shire Local Environmental Plan 2000 (Amendment No 6)

Sutherland Shire Local Environmental Plan 2000 (Amendment No 6)

1 Name of plan

This plan is *Sutherland Shire Local Environmental Plan 2000 (Amendment No 6)*.

2 Aims of plan

- (1) This plan aims:
 - (a) to rezone the land to which this plan applies from Zone 2 (a1) Residential to Zone 6 (a) Public Recreation under *Sutherland Shire Local Environmental Plan 2000*, and
 - (b) to maintain the foreshore scenic protection area nomination over the land.
- (2) This plan also effects law revision by changing an incorrect number of a map which effects the rezoning of land known as 1–7 Robertson Street and part of Harvard Lane, Sutherland.

3 Land to which plan applies

This plan applies to portion of Lot 8, DP 792123 (No 27 The Crescent), portion of Lot 5, DP 792123 (No 31 The Crescent), portion of Lot 2, DP 792547 (No 33 The Crescent), portion of Lot 536, DP 712104 (The Crescent), portion of Lot 537, DP 712104 (The Crescent), portion of Lot 2, DP 717067 (The Crescent), Woronora, as shown edged heavy black on the map marked “Map 23: The Crescent” appearing at the end of this plan and deposited in the office of Sutherland Shire Council.

4 Amendment of Sutherland Shire Local Environmental Plan 2000

Sutherland Shire Local Environmental Plan 2000 is amended as set out in Schedule 1.

Sutherland Shire Local Environmental Plan 2000 (Amendment No 6)

Amendments

Schedule 1

Schedule 1 Amendments

(Clause 4)

[1] Schedule 7 Maps

Renumber “**Map 14: 1–7 Robertson Street and part of Harvard Lane**” as inserted by *Sutherland Shire Local Environmental Plan 2000 (Amendment No 8)* in Government Gazette No 38 on 8 February 2002 (pages 788–790) as “**Map 22: 1–7 Robertson Street and part of Harvard Lane**” and reposition the map (as renumbered) after Map 21.

2002 No 156

Sutherland Shire Local Environmental Plan 2000 (Amendment No 6)

Schedule 1 Amendments

[2] Schedule 7, Map 23: The Crescent

Insert after Map 22 (as renumbered):

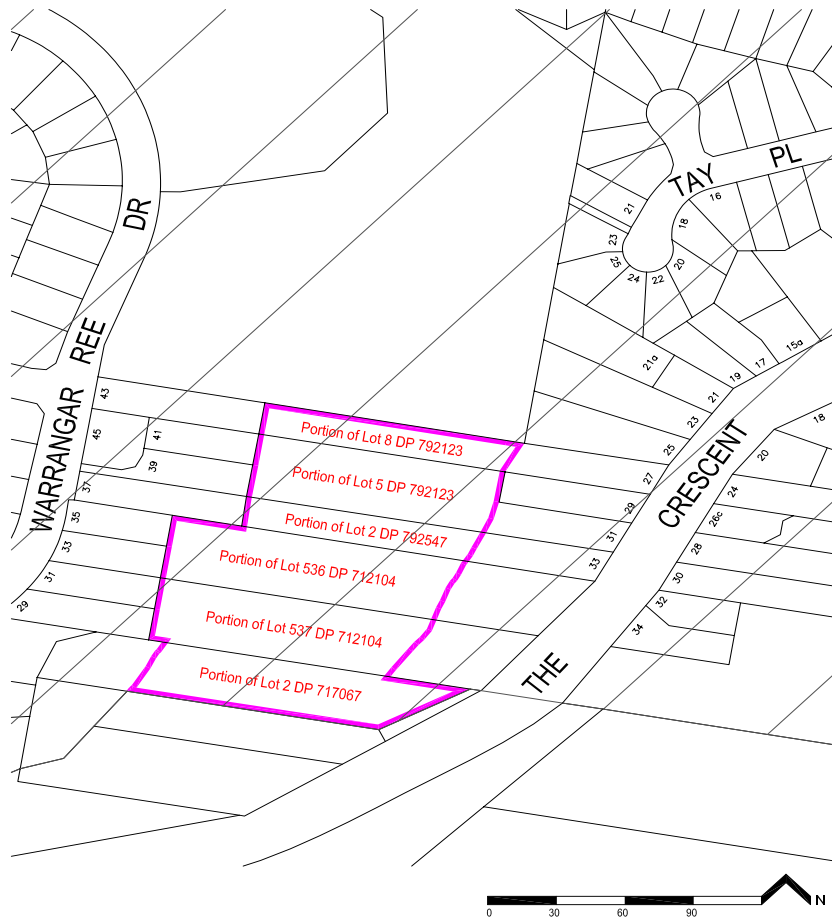

Map 23: The Crescent

Location WORONORA

 6 (a) Public Recreation

BY AUTHORITY