



New South Wales

Sutherland Shire Local Environmental Plan 2000—Amendment No 9

under the

Environmental Planning and Assessment Act 1979

I, the Minister for Urban Affairs and Planning, make the following local environmental plan under the *Environmental Planning and Assessment Act 1979*.
(S99/01825/S69)

ANDREW REFSHAUGE, M.P.,

Minister for Urban Affairs and Planning

2001 No 570

Clause 1 Sutherland Shire Local Environmental Plan 2000—Amendment No 9

Sutherland Shire Local Environmental Plan 2000— Amendment No 9

1 Name of plan

This plan is *Sutherland Shire Local Environmental Plan 2000—Amendment No 9*.

2 Aims of plan

This plan aims to rezone two sites in the Menai district to Zone 7 (b) Environmental Protection (Bushland) under *Sutherland Shire Local Environmental Plan 2000* due to the significance of the Sandstone Shale Transition Forest communities that are found on both sites.

3 Land to which plan applies

This plan applies to Lot 381 DP 839196 Allison Crescent, Menai and to Lot 100 DP 846873 and Lot 602 DP 821377 Hall Drive, Menai, as shown edged pink on the map marked “Map 13: Old Illawarra Rd and Allison Cres” kept in the office of the Council of Sutherland Shire.

4 Amendment of Sutherland Local Environmental Plan—Menai Town Centre 1992

Sutherland Local Environmental Plan—Menai Town Centre 1992 is amended by inserting at the end of clause 4:

- (2) However, this plan does not apply to the land shown rezoned under *Sutherland Shire Local Environmental Plan 2000* on the maps (or sheets of maps) marked as follows:

Sutherland Shire Local Environmental Plan 2000—Amendment No 9

5 Amendment of Sutherland Shire Local Environmental Plan 2000

Sutherland Shire Local Environmental Plan 2000 is amended by inserting at the end of Schedule 7 the following map:

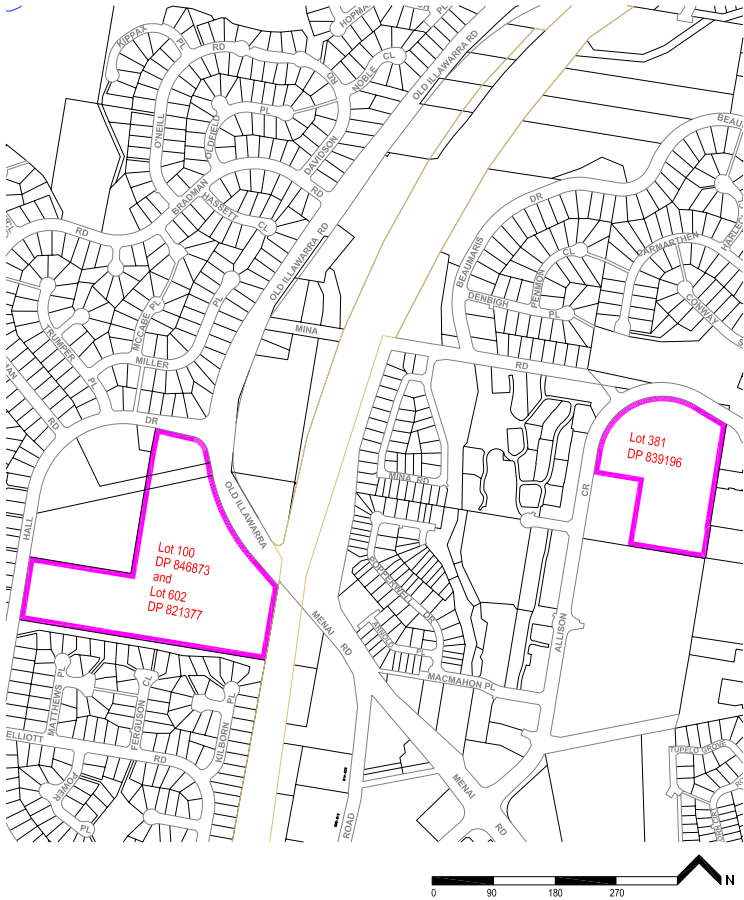

Map 13: Old Illawarra Rd. and Allison Cres.

Location MENAI

7 (b) Environmental Protection (Bushland)

BY AUTHORITY