



New South Wales

Sutherland Shire Local Environmental Plan 2000 (Amendment No 11)

under the

Environmental Planning and Assessment Act 1979

I, the Minister for Planning, make the following local environmental plan under the *Environmental Planning and Assessment Act 1979*. (S01/01414/S69)

ANDREW REFSHAUGE, M.P.,

Minister for Planning

2001 No 1044

Clause 1

Sutherland Shire Local Environmental Plan 2000 (Amendment No 11)

Sutherland Shire Local Environmental Plan 2000 (Amendment No 11)

1 Name of plan

This plan is *Sutherland Shire Local Environmental Plan 2000 (Amendment No 11)*.

2 Aims of plan

This plan aims:

- (a) to rezone part of the land to which this plan applies from various residential and special uses zones to partly Zone 6 (a) Public Recreation and partly Zone 6 (a) Public Recreation–Foreshore Scenic Protection Area under *Sutherland Shire Local Environmental Plan 2000*, and
- (b) to rezone the remainder of the land from Zone 6 (a) Public Recreation to Zone 2 (a1) Residential–Foreshore Scenic Protection Area under the 2000 plan.

3 Land to which plan applies

This plan applies to the following land situated within the local government area of Sutherland:

- (a) Lot 13, DP 9018 (No 12 Denman Avenue, Woollooware) and Lot 1, DP 440601 (No 12R Wills Road, Woollooware), as shown edged heavy black on the map marked “Map 14: 12 Denman Avenue 12R Wills Road,”
- (b) Lots 20–22, Section 2, DP 8670 (Nos 94, 95 and 96 The Esplanade, Cronulla), as shown edged heavy black on the map marked “Map 15: 94, 95, 96 The Esplanade”
- (c) Lots 145–148, DP 8505 (Nos 6, 8, 10 and 12 Castelnau Street, Caringbah), as shown edged heavy black on the map marked “Map 16: 6, 8, 10, 12 Castelnau Street”
- (d) Lots A and B, DP 360826 (No 38 Canberra Road, Sylvania and No 5 Melrose Avenue, Sylvania) and Lot 1, DP 417212 (No 3 Melrose Avenue, Sylvania), as shown edged heavy black on the map marked “Map 17: 38 Canberra Road, 3, 5 Melrose Avenue”

-
- (e) Lots 19, 18 and 17, DP 808727 (Nos 68, 70 and 72 Landor Road, Barden Ridge) and Lot 20, DP 808727 (No 11 Parsons Place, Barden Ridge), as shown edged heavy black on the map marked “Map 18: 68, 70, 72 Landor Road, 11 Parsons Place”,
 - (f) Lot 1, DP 219900 (No 66 Karimbla Road, Miranda) and Lot 2, DP 570622 (Nos 68–74 Karimbla Road, Miranda), as shown edged heavy black on the map marked “Map 19: 66–74 Karimbla Road”,
 - (g) Lot 131, DP 739409 (No 9 Bassia Place, Alford's Point), as shown edged heavy black on the map marked “Map 20: 9 Bassia Place”,
 - (h) Lot 75, DP 739409 (No 12 Burrawang Place, Alford's Point), as shown edged heavy black on the map marked “Map 21:12 Burrawang Place”,

deposited in the office of Sutherland Shire Council.

4 Amendment of Sutherland Shire Local Environmental Plan 2000

Sutherland Shire Local Environmental Plan 2000 is amended as set out in Schedule 1.

2001 No 1044

Sutherland Shire Local Environmental Plan 2000 (Amendment No 11)

Schedule 1 Amendment

Schedule 1 Amendment

(Clause 4)

Schedule 7 Maps

Insert after Map 13:



**Map 14: 12 Denman Avenue
12R Wills Road,**

LOCATION WOOLLOOWARE

 6(a) Public Recreation



Map 15: 94,95,96 The Esplanade

LOCATION CRONULLA

 6 (a) Public Recreation - Foreshore Scenic Protection Area

2001 No 1044

Sutherland Shire Local Environmental Plan 2000 (Amendment No 11)

Schedule 1 Amendment



Map 16: 6,8,10,12 Castelnau Street

LOCATION CARINGBAH

 6(a) Public Recreation



Map 17: 38 Canberra Road,
3,5 Melrose Avenue

LOCATION SYLVANIA

 6(a) Public Recreation

2001 No 1044

Sutherland Shire Local Environmental Plan 2000 (Amendment No 11)

Schedule 1 Amendment

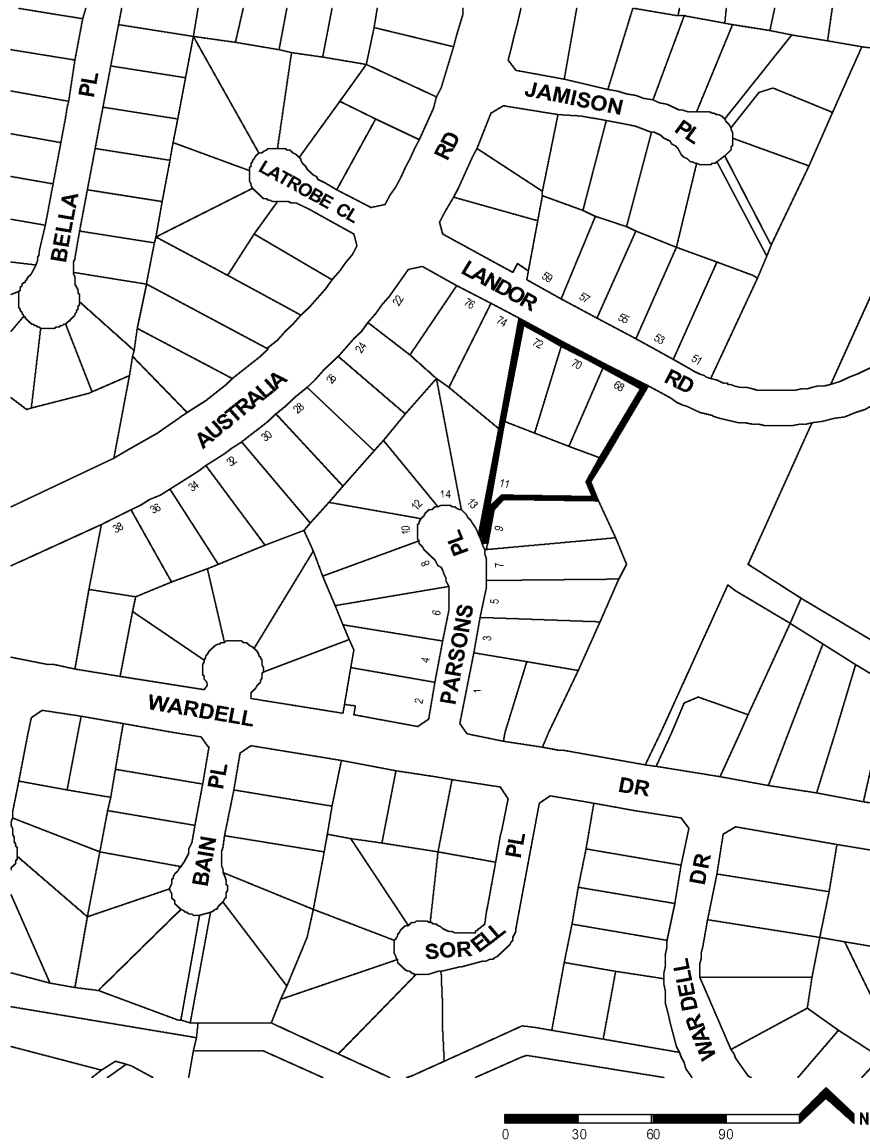

**Map 18: 68,70,72 Landor Road,
11 Parsons Place**

LOCATION BARDEN RIDGE

 6(a) Public Recreation

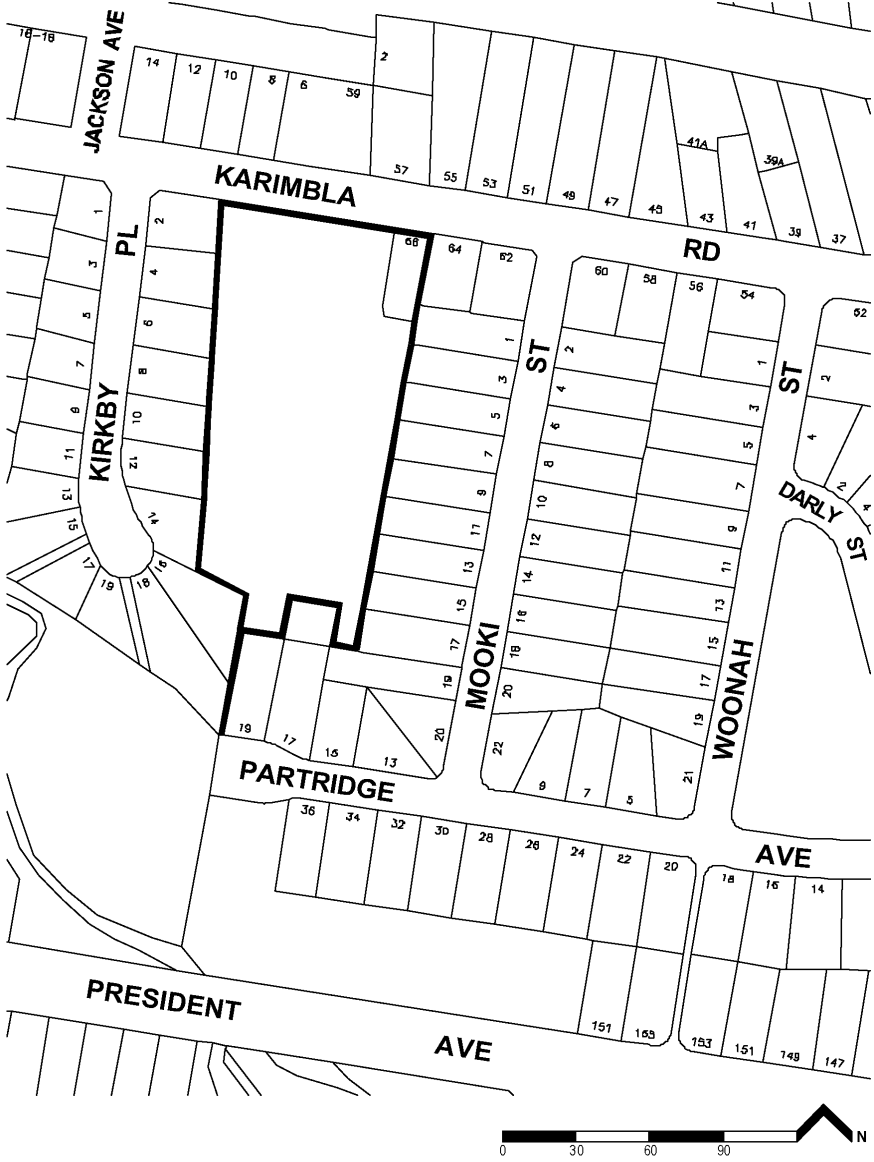

Map 19: 66-74 Karimbla Road

LOCATION MIRANDA

6(a) Public Recreation

2001 No 1044

Sutherland Shire Local Environmental Plan 2000 (Amendment No 11)

Schedule 1 Amendment

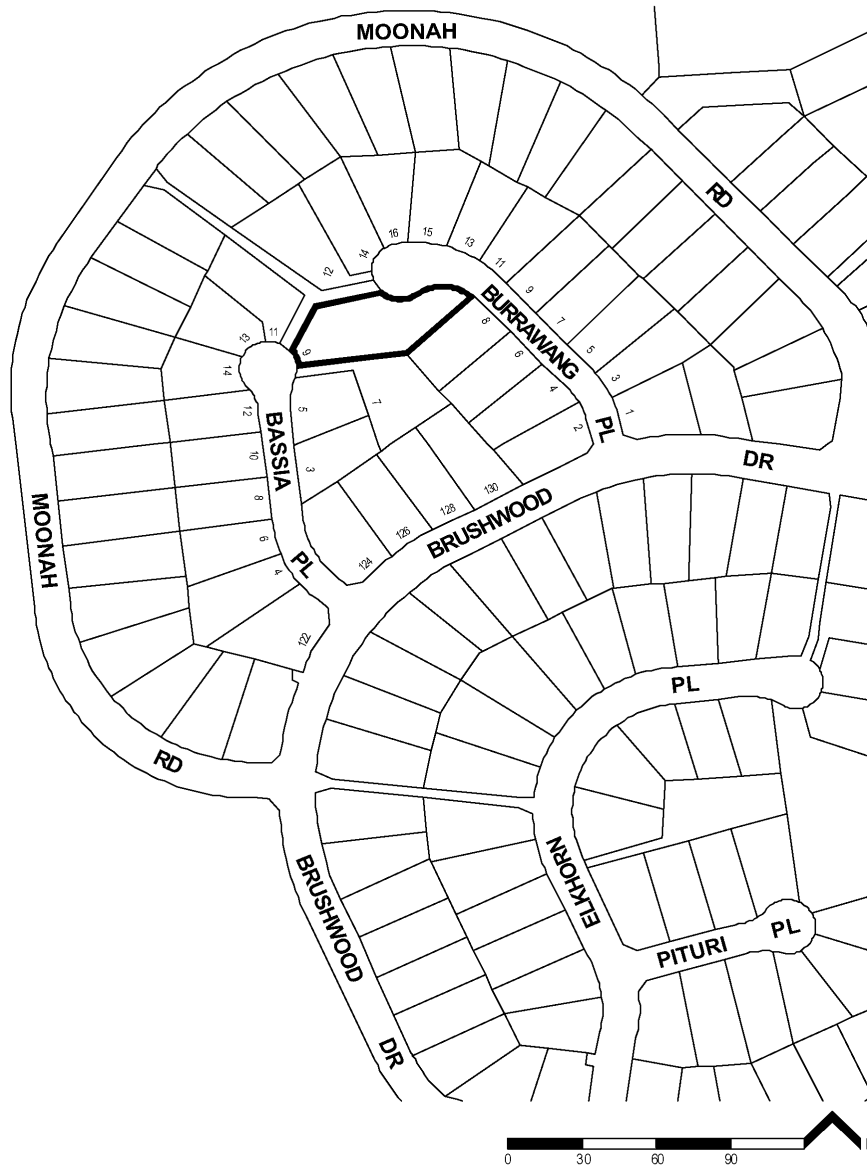

Map 20: 9 Bassia Place

LOCATION ALFORDS POINT

 6(a) Public Recreation - Foreshore Scenic Protection Area

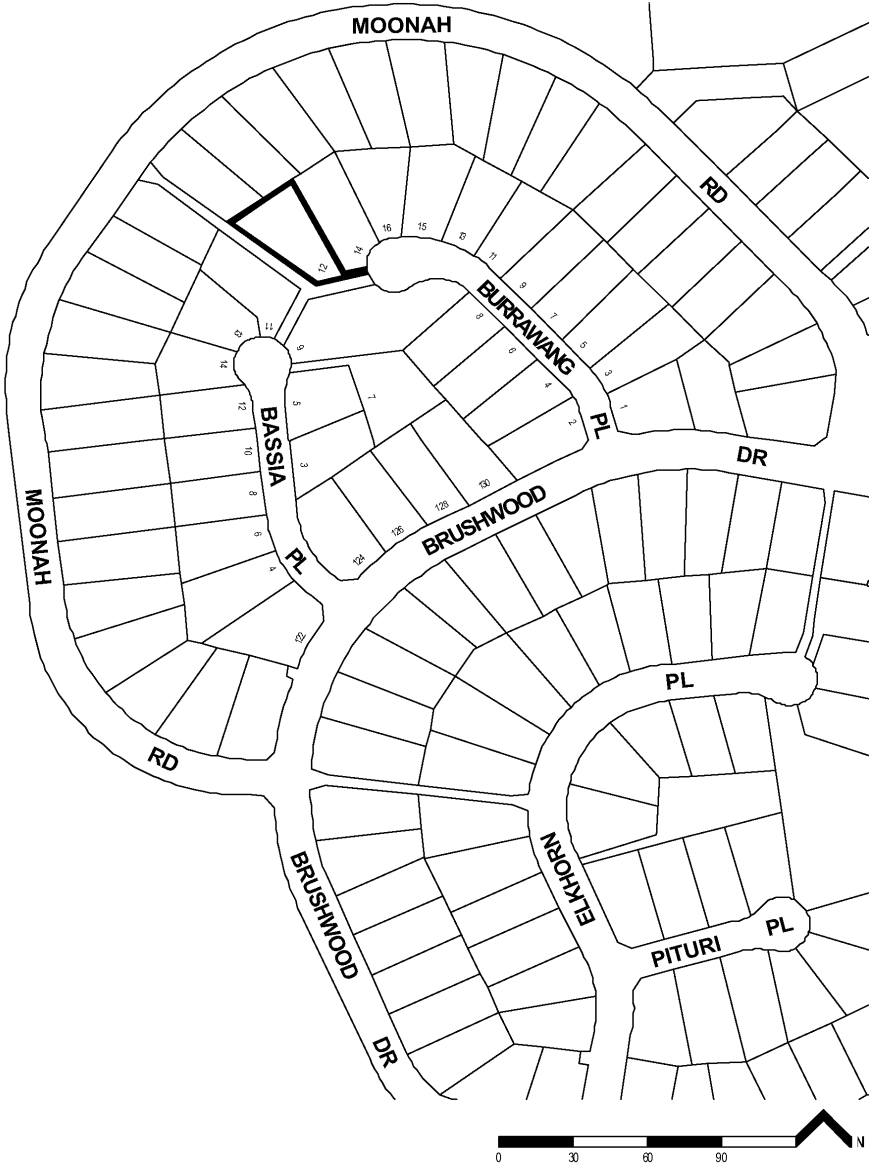

Map 21: 12 Burrawang Place

LOCATION ALFORDS POINT

2 (a1) Residential - Foreshore Scenic Protection Area BY AUTHORITY